

Pressure gauge push-button stop cock

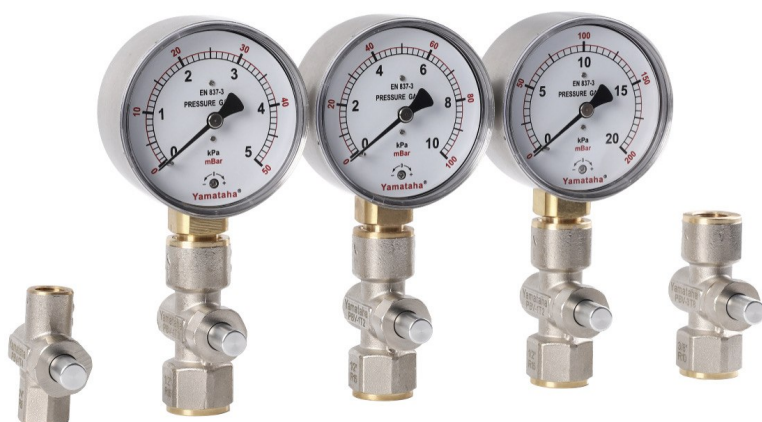

Application

Shut-off element between measuring line and pressure gauge. Normally, the push-button stop cock is closed. In this state, there is no pressure applied to the pressure gauge. Push the button to apply pressure to the pressure gauge and to display the operating pressure. With connection as per DIN EN 10226-1 suitable for gases as per DVGW G260 and SVGW.

Technical specifications

Operating temperature range

Medium: 0/70 °C
Ambient: -20/+60 °C

Nominal pressure

5 bar (MOP 5)

Connection

Female x
female

Rp 1/4"

Rp 1/2"

Rp 3/8"

Housing

Brass, nickel-plated

Technical drawings

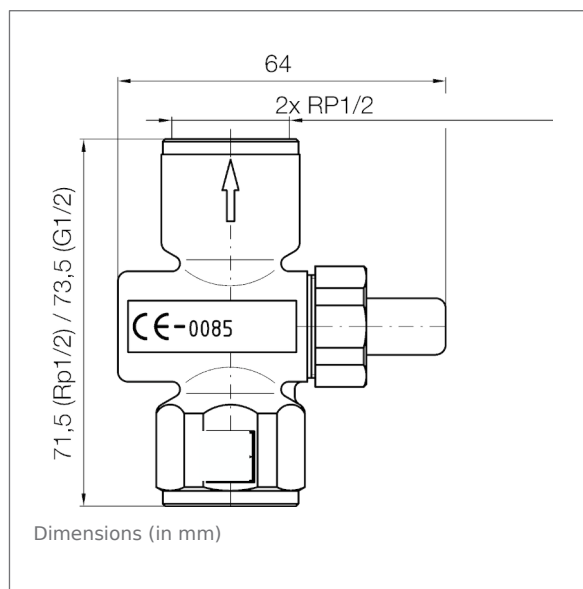
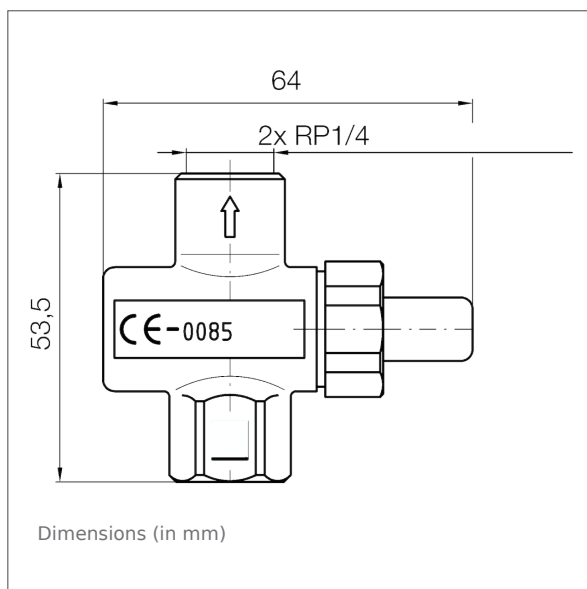

Versions

Pressure gauge push-button stop cock female x female

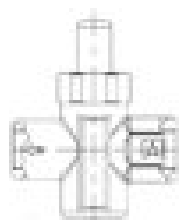

Connection	Nominal pressure	Material	Type
Rp 1/4	5 Bar / 70PSI	Brass, nickel-plated	PBV-1T4
Rp 1/2	5 Bar / 70PSI	Brass, nickel-plated	PBV-1T2
RP3/8	5 Bar / 70PSI	Brass, nickel-plated	PBV-3T8

Yamataha
www.add-furnace.com

Email: sales@add-furnace.com

Tel: 02-888-3472

Fax: 02-888-3258

Mobile: 088-300-1122 / 08-08-170-170